

CAMERA VIEW SCREEN

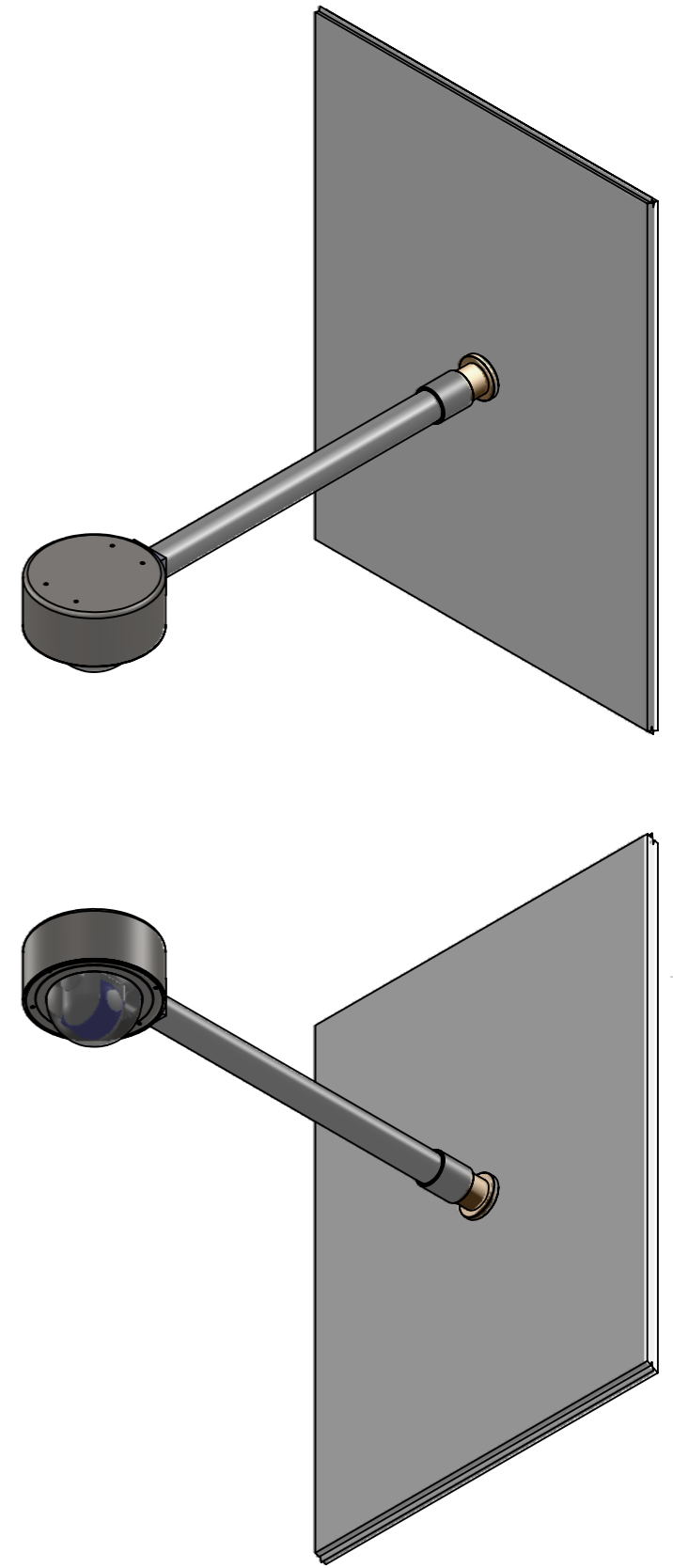
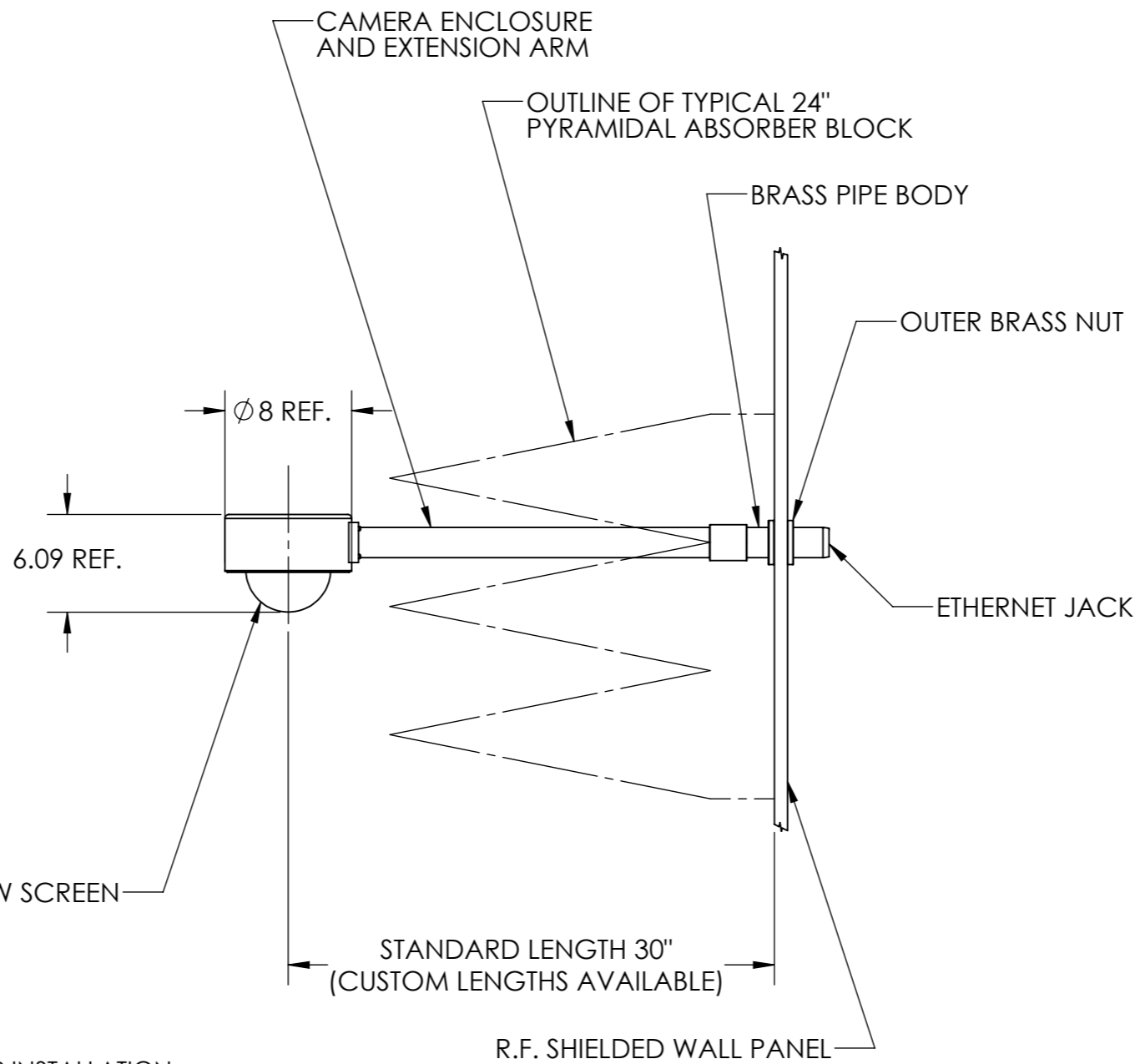

INSTALLATION:

- DETERMINE PREFERRED LOCATION ON CHAMBER WALL FOR INSTALLATION.
- REMOVE ANY ABSORBER OR FINISHES THAT LIMIT ACCESS TO THAT AREA OF THE WALL.
- DRILL A  $\phi$  2" HOLE THROUGH THE WALL. DEBURR BOTH SIDES OF THE HOLE.
- LIGHTLY SCUFF BOTH SIDES OF THE SHIELD PANEL AROUND THE HOLE WITH A MEDIUM SCOTCH-BRITE PAD, THEN WIPE CLEAN WITH A RAG AND METHYL HYDRATE.
- REMOVE THE OUTERMOST BRASS NUT FROM THE ASSEMBLY, THEN INSERT THE THREADED BRASS PIPE BODY THROUGH THE HOLE. RE-INSTALL THE BRASS NUT ON THE OUTSIDE OF THE ENCLOSURE.
- LEVEL THE CAMERA HOUSING AND THEN COMPLETELY TIGHTEN THE BRASS NUTS.
- INSTALL THE ETHERNET CABLE BETWEEN THE JACK IN THE END OF THE BRASS PIPE BODY AND THE OUTPUT OF THE P.O.E. POWER INJECTOR (NOT SHOWN).
- CONNECT P.O.E. POWER INJECTOR TO ITS POWER ADAPTOR AND TO THE CONTROL COMPUTER, FOLLOWING THE INSTALLATION STEPS PER THE CAMERA SOFTWARE GUIDE.
- RE-INSTALL ABSORBER, OR FINISHES, AS REQUIRED.

THIS DRAWING AND DESIGN INCLUDING ALL NOVEL AND PATENTABLE FEATURES SEPARATELY OR COLLECTIVELY DISCLOSED AND INCLUDED THEREIN ARE THE PROPERTY OF RAYMOND EMC ENCLOSURES LTD AND ACCEPTANCE OF THIS PRINT CONSTITUTES AN AGREEMENT THAT IT WILL BE TREATED AS A CONFIDENTIAL DOCUMENT AND WILL BE USED IN THE ASSEMBLY OR OPERATION OF EQUIPMENT FURNISHED BY RAYMOND EMC ENCLOSURES LTD. THIS DRAWING SHALL NOT BE REPRODUCED, COPIED, LENT, DISCLOSED, PUBLISHED OR DISPOSED OF DIRECTLY OR INDIRECTLY NOR USED FOR ANY PURPOSE OTHER THAN THAT FOR WHICH IT IS SPECIFICALLY FURNISHED EXCEPT AS EXPRESSLY AUTHORIZED IN WRITING BY RAYMOND EMC ENCLOSURES LTD.

UNLESS OTHERWISE SPECIFIED: DIMENSIONS ARE IN INCHES SURFACE FINISH: TOLERANCES: LINEAR: ANGULAR:		FINISH:	DEBUR AND BREAK SHARP EDGES	DO NOT SCALE DRAWING	REVISION 0
DRAWN D.E.C.		SIGNATURE	DATE 2011/10/24	<p><b>REMC</b> R.F. CAMERA ENCLOSURE</p>	
CHK'D					
APPV'D					
MFG					
Q.A					
MATERIAL:			DWG NO.	A3	
WEIGHT:			CAMERA ENCLOSURE INSTALLATION		
			SCALE:1:12	SHEET 1 OF 1	